

TRPA Advisory Planning Commission

Kings Beach State Recreation Area General Plan Revision and Pier Rebuild Project Draft EIR/EIS

June 13, 2018



Purpose of Today's Presentation

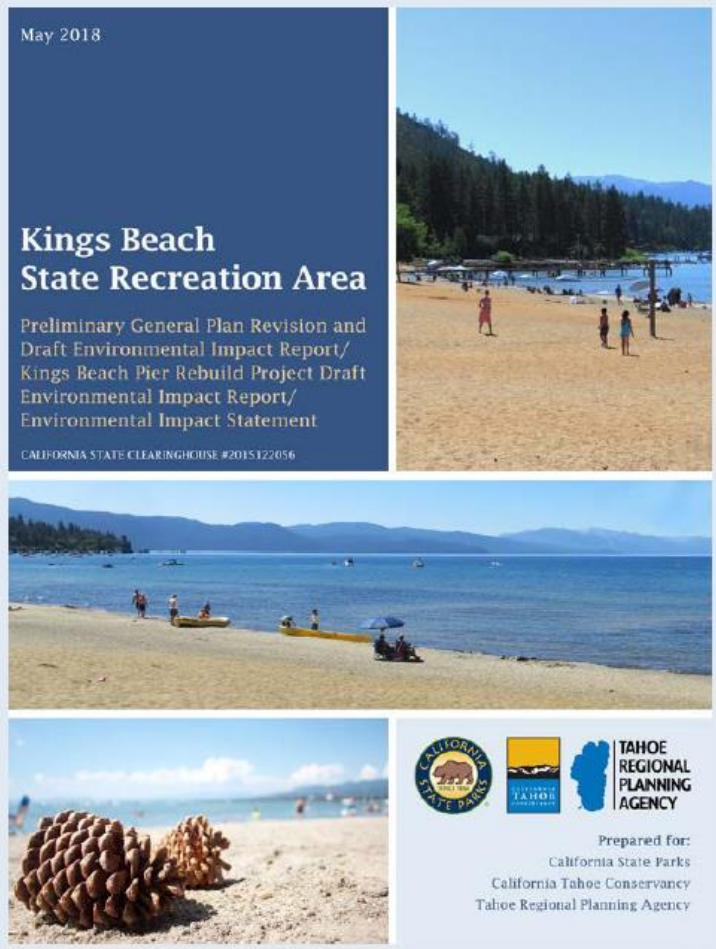

- Present EIR/EIS Summary
- Present Pier Rebuild Project Alternatives
- Public Comment on Pier Rebuild Project Portion of Document



KBSRA Pier Rebuild Project

KBSRA General Plan
Revision and Pier
Rebuild Project
EIR/EIS

General Plan
Revision

General Plan
Environmental
Analysis

Pier Rebuild
Project
Environmental
Analysis



KBSRA Pier Rebuild Project

**Recreation
EIP
Project**



Improving Lake Access



**Increasing Recreation
Space**



Increased Functionality

KBSRA Pier Rebuild Project



Shoreline Permitting Transition Process

Consistent with the Partial Permitting Program

Consistent with the Proposed Shoreline Code



KBSRA Pier Rebuild Project

Anticipated Timeline



TRPA APC Meeting Draft EIS



Kings Beach State Recreation Area

General Plan Revision/Pier Rebuild Project

June 13, 2018



General Plan Revision

KINGS BEACH STATE RECREATION AREA

PRELIMINARY GENERAL DEVELOPMENT PLAN AND RESOURCE MANAGEMENT PLAN

Prepared for:
State of California
Department of Parks and Recreation
July 1980

- Long-term management
- Replaces 1980 plan
- Goals, guidelines, improvements



Document Components





- General Plan Revision
- General Plan EIR
- Pier Rebuild Project EIR/EIS
- Combined document

May 2018



Kings Beach State Recreation Area

Preliminary General Plan Revision and Draft Environmental Impact Report/
Kings Beach Pier Rebuild Project Draft Environmental Impact Report/
Environmental Impact Statement

CALIFORNIA STATE CLEARINGHOUSE #2015122056



Prepared for:
California State Parks
California Tahoe Conservancy
Tahoe Regional Planning Agency



Process and Timeline

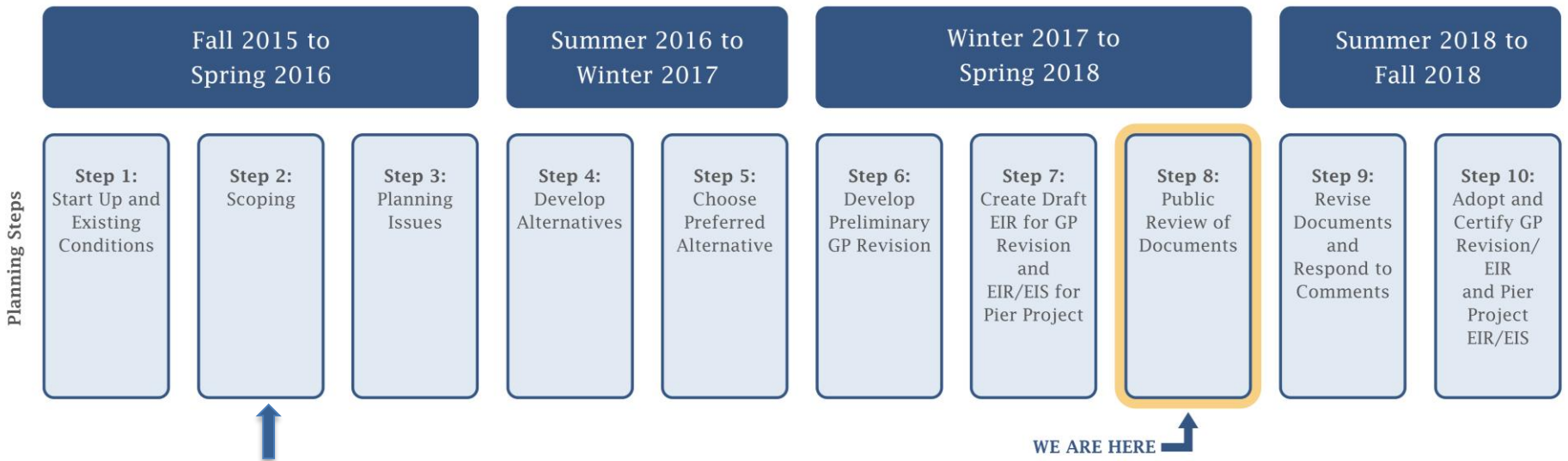

PRESENTED TO:

- TRPA ADVISORY PLANNING COMMISSION
- SHORELINE REVIEW COMMITTEE



Pier Rebuild Project



- Access to and from the lake
- Comparative alternative analysis completed in early 2016
- Three pier rebuild alternatives and a no project alternative



Alternative Features

Alternative 1 - No Project

- Central pier (fixed; 207 feet)
- Motorized boat ramp
- Parking (177 spaces)

Alternative 2 - Eastern Pier Alternative (Proposed Project)

- Rebuilt pier (fixed/floating; 488 feet)
- Lake access point
- Swim buoy area
- Reduced/reconfigured parking (157 spaces; 11% reduction)
- Beachfront promenade with overlooks

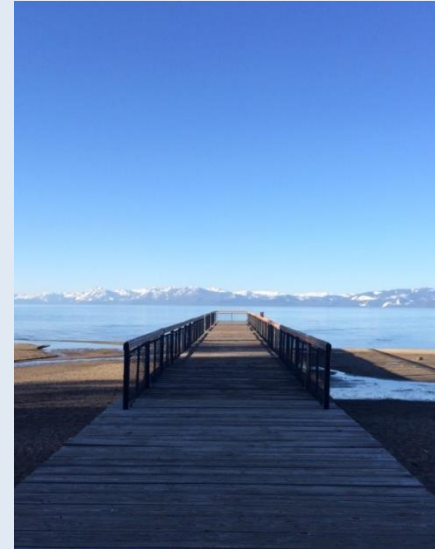

Alternative 3 - Central Pier Alternative

- Rebuilt pier (fixed/floating; 601 feet)
- Lake access point
- Expanded parking (183 spaces; 3% increase)
- Beachfront promenade

Alternative 4 - Western Pier Alternative

- Rebuilt pier (fixed/floating; 704 feet)
- Motorized boat ramp extended slightly
- Reduced parking (119 spaces; 33% reduction)
- Beachfront promenade with overlooks

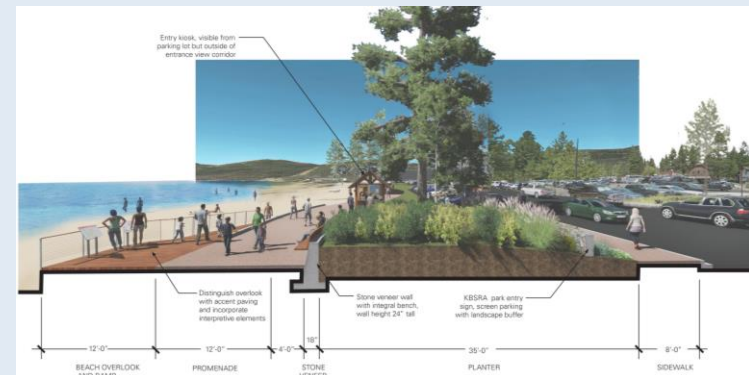

Pier Alternative Comparison

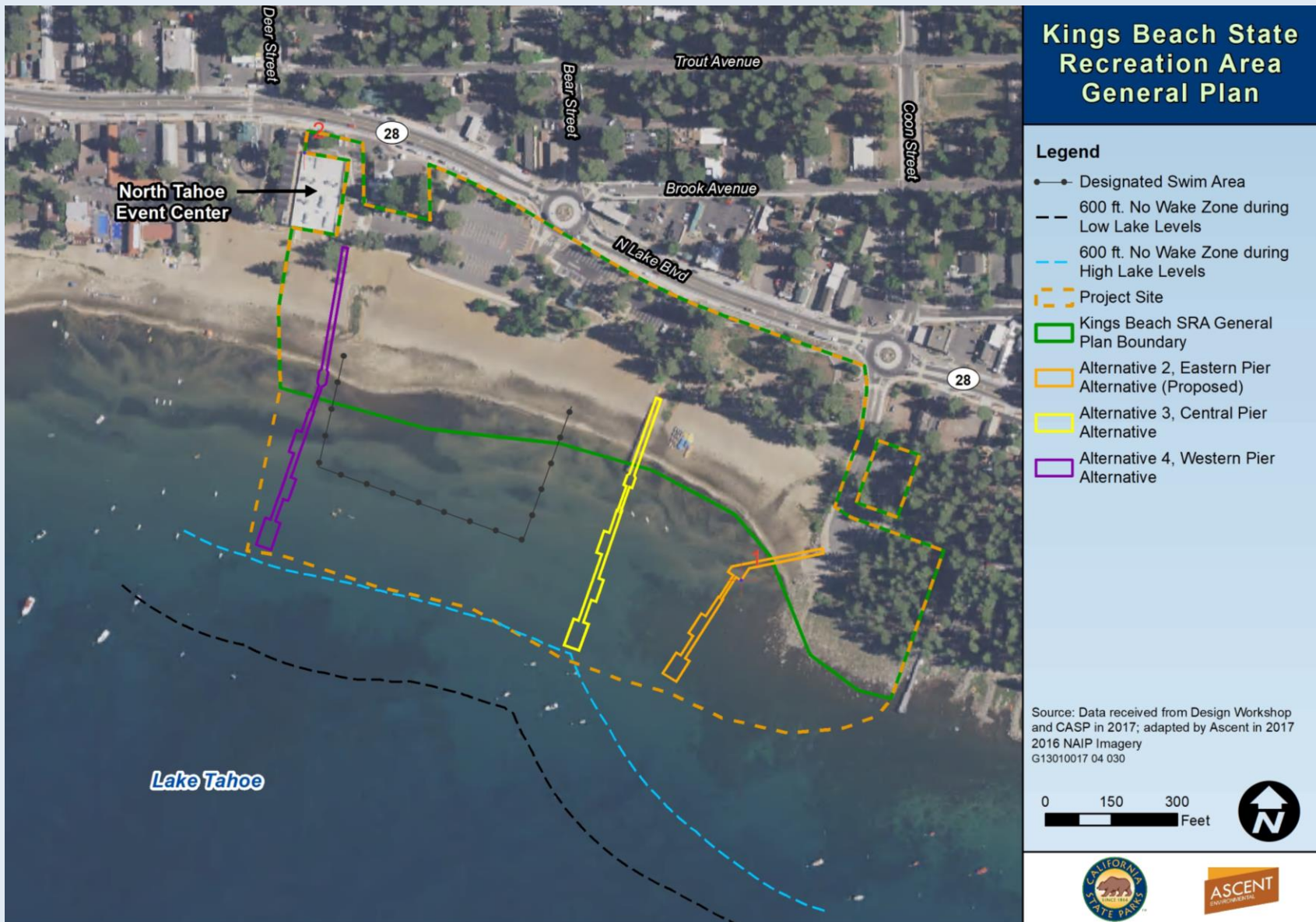

Proposed Project



- | | | |
|--|---|---|
| ① Pier | ⑫ Beach access - pedestrian | ⑳ New comfort station (2 stall/2 changing rooms) |
| ② Waterfront Promenade & sand wall | ⑬ Non-motorized beach access ramp | ㉑ New comfort station (10 stall/2 changing rooms) |
| ③ Open lawn area with section of reinforced turf for vehicular access to stage | ⑭ Nature play area | ㉒ Existing comfort station (4 stall) |
| ④ Stage/event area | ⑮ Sand volleyball | ㉓ Administrative building (1 stall comfort station) |
| ⑤ Viewpoints/nodes along Promenade | ⑯ Relocated basketball court | ㉔ Concessionaire building |
| ⑥ Eastern entry plaza | ⑰ Boat and kayak rentals | ㉕ Dumpster enclosure |
| ⑦ Western entry plaza with connection from street to park | ⑱ Reconfigured parking lot | ㉖ Seasonal non-motorized boat storage |
| ⑧ Group picnic pavilion | ㉚ Staff parking area | ㉗ Existing stormwater outfall |
| ⑨ Small group picnic pavilion | ㉛ Drop-off areas | ㉘ Existing stormwater basin |
| ⑩ Individual picnic sites, typ. | ㉜ Existing, underground stormwater infrastructure | ㉙ Dog beach (leashed) |
| ⑪ Beach access - 10' wide, paved | ㉝ Entry kiosk | |

Parking



- Improved configuration and circulation
- Automatic payment machines (APMs)
- Drop-off locations
- Promenade
- Non-motorized watercraft storage
- Bike racks
- Transit stop



Lake Access Point



- Universally accessible pedestrian access to beach
- Boat launching dedicated to non-motorized watercraft
- Easy kayak and paddleboard access with onsite storage
- Usable at all lake levels



Boat Ramp



- Removed as mitigation for eastern pier
- Shallow shelf
- Avoid boat trailer overflow
- No need to add inspection station



Eastern Pier

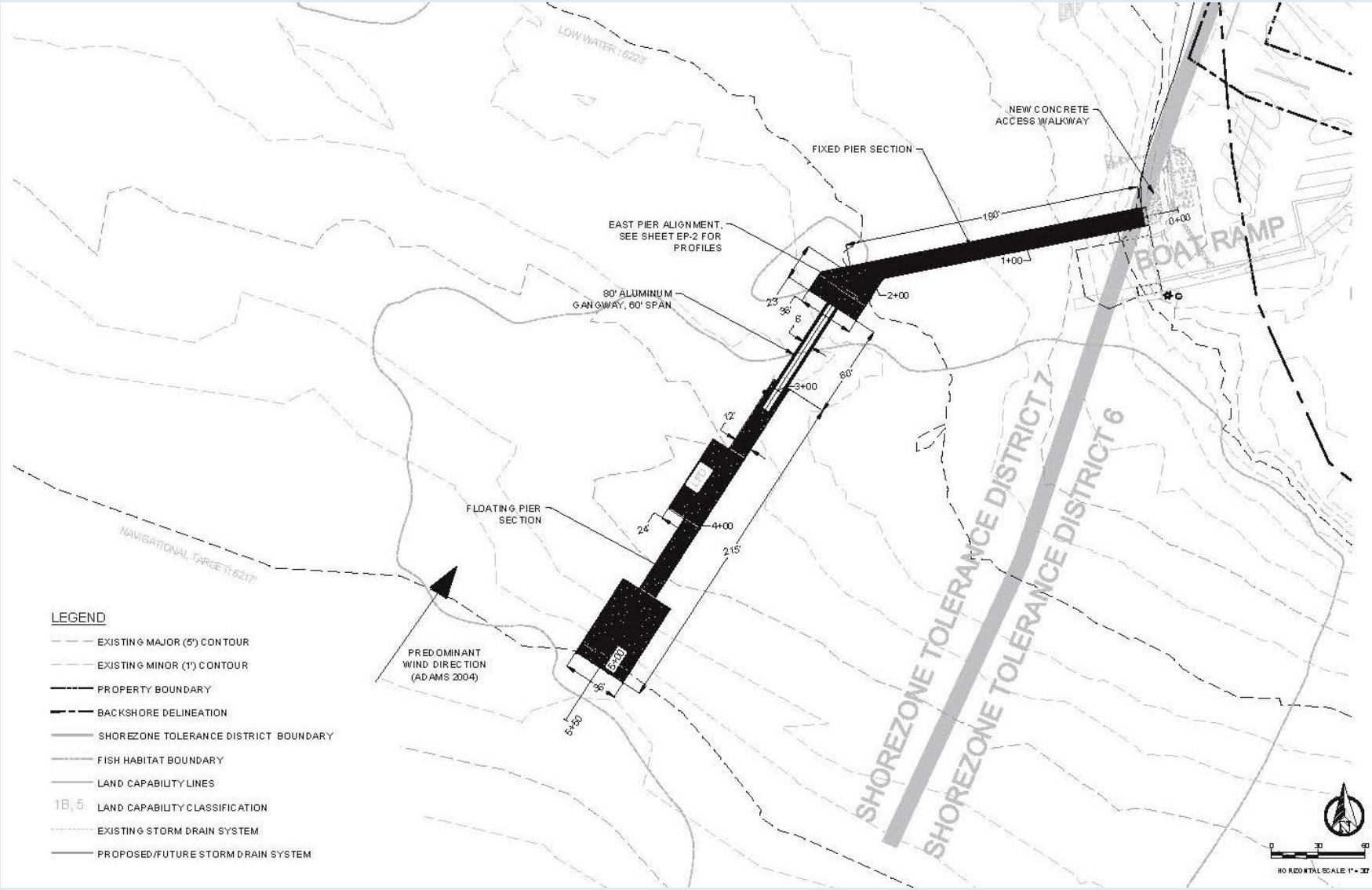

LEGEND

- EXISTING MAJOR (5') CONTOUR
- EXISTING MINOR (1') CONTOUR
- PROPERTY BOUNDARY
- BACKSHORE DELINEATION
- SHOREZONE TOLERANCE DISTRICT BOUNDARY
- FISH HABITAT BOUNDARY
- LAND CAPABILITY LINES
- 1B, 5 LAND CAPABILITY CLASSIFICATION
- EXISTING STORM DRAIN SYSTEM
- PROPOSED/FUTURE STORM DRAIN SYSTEM

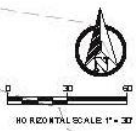

Eastern Pier

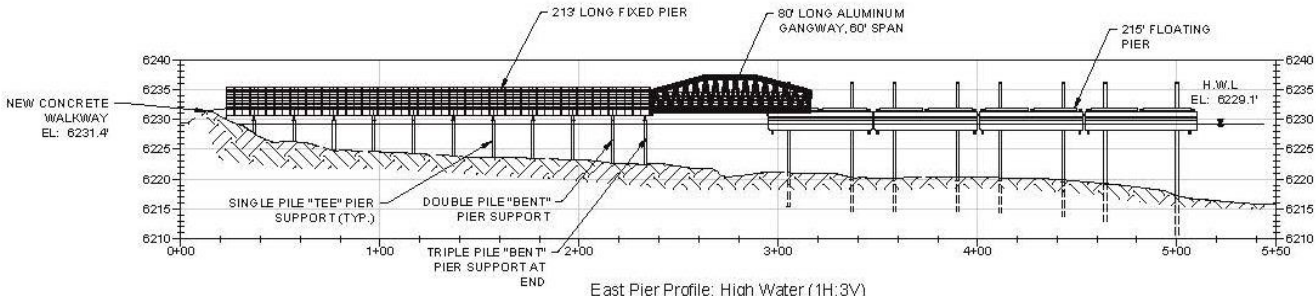

East Pier Profile: High Water (1H:3V)

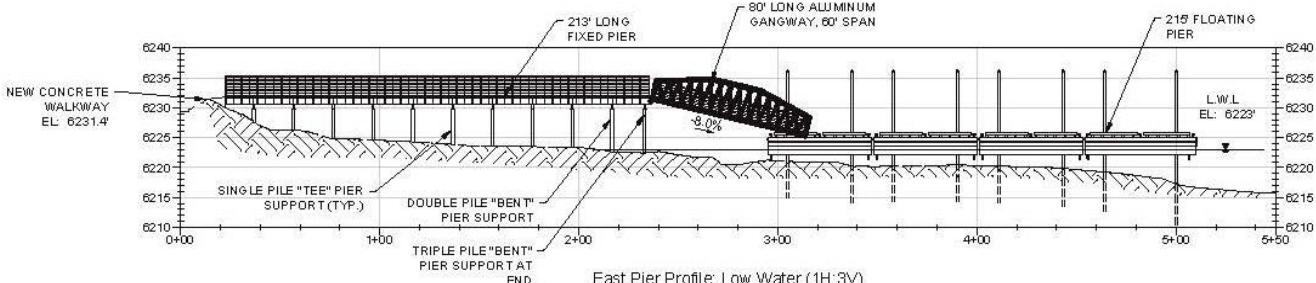

East Pier Profile: Low Water (1H:3V)

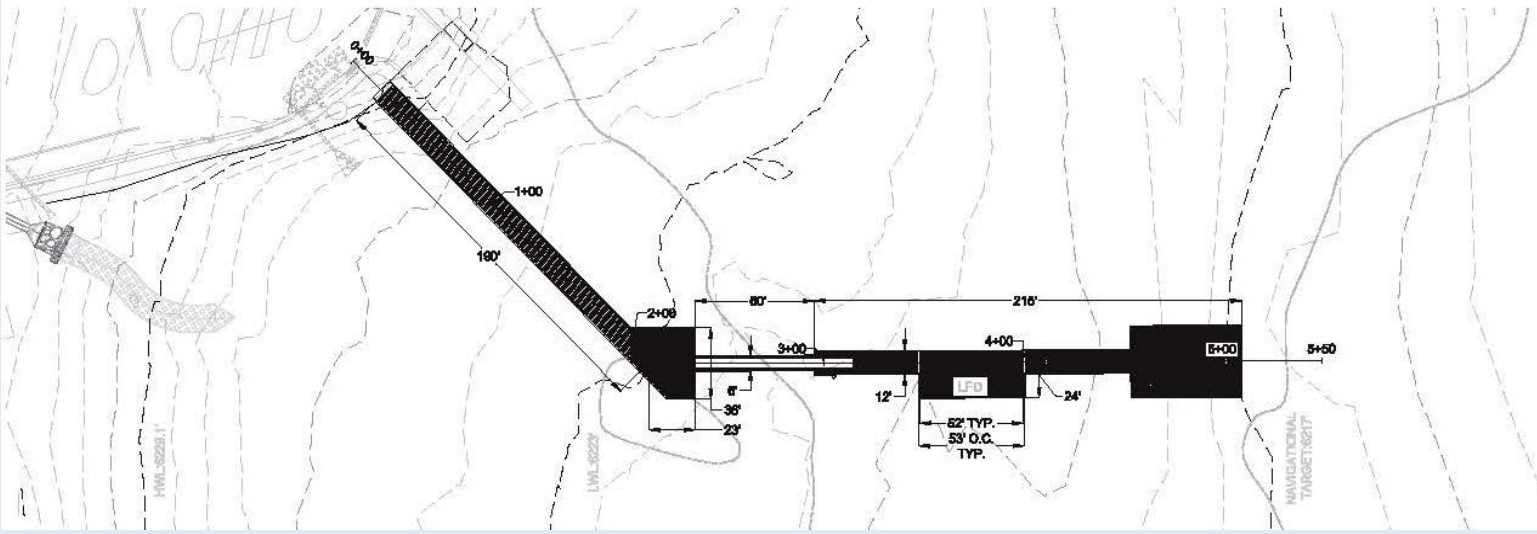

Navigating the Draft Document



- Executive Summary
- Ch. 1, Introduction
- Ch. 2, Existing Conditions
- Ch. 3, Issues and Analysis
- Ch. 4, The Plan
- Ch. 5, Environmental Analysis
- Ch. 6, References
- Ch. 7, Glossary
- Ch. 8, Report Preparers



Contents of Chapter 5

- Alternatives
- Cumulative Setting
- Air Quality
- Biological Resources
- Cultural Resources
- Greenhouse Gas Emissions and Climate Change
- Geology, Soils, Land Capability, and Coverage
- Hazards, Hazardous Materials, and Risk of Upset
- Hydrology and Water Quality
- Land Use and Planning
- Noise
- Public Services and Utilities
- Recreation
- Scenic Resources
- Transportation and Circulation



Fisheries

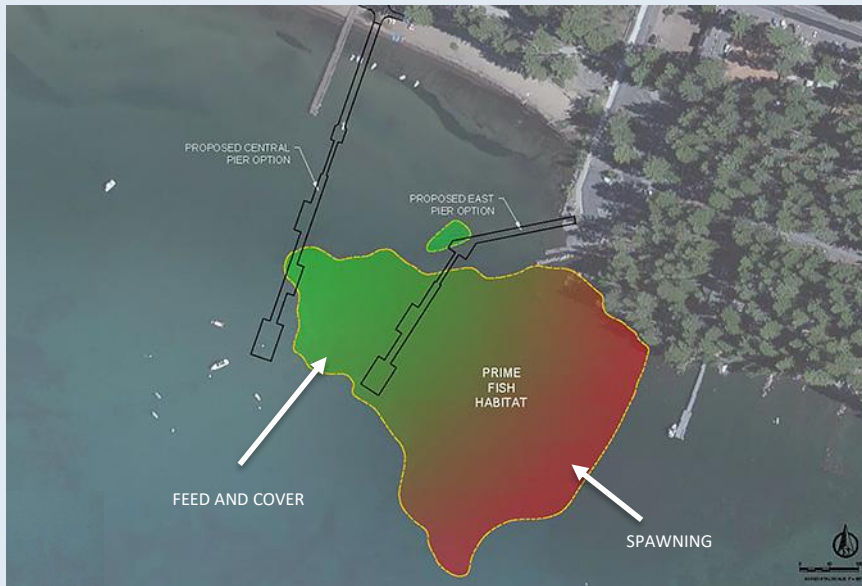

- Fully mitigated prime fish habitat



Pier-Based Recreation



- Access and opportunities for motorized watercraft
- Safe navigation for swimmers and non-motorized watercraft



Scenic Resources



- Views from the shore (beach and road)
- Views from the lake



Other Resources

Less than significant impacts

Land Use and Planning

Public Services and Utilities

Greenhouse Gas Emissions and Climate Change

Other impacts avoided with CSP standard project requirements

Air Quality

Hydrology and Water Quality

Geology, Soils, Land Capability
and Coverage

Noise

Hazards, Hazardous Materials,
and Risk of Upset

Transportation and Circulation

Other impacts requiring mitigation

Cultural Resources

Document Availability

- Hard copies available for review through project approval at:
 - CSP Sierra District offices
 - TRPA offices
 - North Tahoe Event Center
 - NTPUD offices
 - Kings Beach Library
 - Donner Memorial State Park
- Project webpage at: www.parks.ca.gov/PlanKBSRA



Next Steps



- TRPA Governing Board on June 27, 2018
- Public review ends June 29, 2018
- Final General Plan Revision and EIR/Pier Rebuild EIR/EIS
- Project approval/certification hearings scheduled for fall 2018



For Further Information

Marilyn Linkem
Superintendent
California State Parks, Sierra District
Phone: 503.525.9523
email: plan.general@parks.ca.gov

Tiffany Good
Senior Planner
Tahoe Regional Planning Agency
Phone: 775.589.5282
email: tgood@trpa.org



Thank you for your participation!

