STAFF REPORT

Date: May 4, 2022

To: TRPA Advisory Planning Commission

From: TRPA Staff

Subject: TRPA Code of Ordinance shoreline amendments regarding buoy fields and new mooring buoys

Summary and Staff Recommendation:

Staff will present an overview of proposed amendments to the TRPA Code of Ordinances Chapter 2 and Chapter 84. An amendment to code section 84.3.3.E.3 would authorize existing non-littoral Home Owners' Association (HOA) buoy fields. An amendment to section 2.2.2.F.2.b allows for staff-level approval of new mooring buoys on eligible private, single-family littoral parcels. These amendments ensure that the Code reflects the existing condition of non-littoral HOA buoy fields and streamlines the approval process for eligible mooring buoys. The amendments were recommended with unanimous support from the Shoreline Steering Committee on January 21, 2022. On April 27, 2022, the Regional Plan Implementation Committee (RPIC) unanimously recommended the amendments for approval by the Governing Board. Staff seeks Advisory Planning Commission (APC) discussion and recommendation of approval to the TRPA Governing Board for adoption of the proposed code amendments.

Motion:

To recommend adoption of the code amendments, APC must make the following motion(s), based on the staff summary:

- 1) A motion to recommend approval of the Required Findings, as described in Attachment B, including a Finding of No Significant Effect, for adoption of the Code of Ordinances amendments as described in the staff summary; and
- 2) A motion to recommend adoption of Ordinance 2022-___, amending Ordinance 87-9, to amend the Code of Ordinances as shown in Attachment A.

An affirmative vote of a majority of the quorum present is required for a motion to pass.

Discussion:**1. Proposed Amendments to Code Section 84.3.3.E.3 (Existing Buoys)**

The TRPA Governing Board approved the Shoreline Plan in October 2018. The plan supports boating, paddling, swimming, and other water-based recreation, while also ensuring effective natural resource management for continued attainment of environmental goals in the Lake Tahoe Region. The Shoreline Plan included implementation measures in the TRPA Code of Ordinances Chapter 84 including the authorization of preexisting buoy fields, prohibition on new buoy fields, and standards for private mooring buoys. The permit review process for shoreline projects is detailed in Chapter 2 of the Code.

While the 2018 Shoreline Plan explicitly prohibited new buoy fields, buoy fields existing legally prior to the amendment were allowed to remain. The 2018 code amendments include specific provisions to allow homeowner association's (HOA) to maintain buoy fields located offshore of littoral parcels that existed prior to 2018. However, the Code does not specifically address HOA buoy fields that service *non-littoral* parcels without an associated littoral parcel.

The Shoreline Implementation Committee and TRPA staff view the omitted authorization of pre-existing non-littoral HOA buoy fields during the 2018 adoption of the TRPA Shoreline Plan and associated code amendments as an oversight requiring correction. The proposed amendment to section 84.3.3.E.3 will expressly allow littoral and non-littoral buoy fields for HOAs possessing a valid permit issued by a federal or state agency with appropriate jurisdiction prior to September 1, 2018. It does not affect the prohibition on new buoy fields (84.3.3.E.1).

2. Proposed Amendments to Code Section 2.2.2.F.2.b (New Structures)

Amendments to Section 2.2.2.F.2.b address the review and approval process for eligible private, single-family buoys. Section 2.2.2.F.2 requires Hearings Officer review and approval for all new structures within the shorezone. The section has been interpreted to require Hearings Officer approval for all mooring buoys including the relatively routine approval of new mooring buoys for eligible private, single-family littoral parcels.

Unless otherwise stated, private, single-family littoral parcels are allowed two mooring buoys (84.3.2.A). The approval is largely administrative in nature, involving conformance review which the shoreline implementation committee and TRPA staff believe is compatible with staff-level review and approval. Staff also believe that the amendment will relieve an application backlog and unnecessary burden on the Hearings Officer which could otherwise be directed to more complex projects with greater potential impacts on TRPA's threshold standards. The proposed amendments will allow mooring buoys associated with eligible private, single-family littoral parcels to be permitted at the staff-level. The amendment will not change the conformance requirements for mooring buoys on private, single-family parcels and will not alter the review and approval requirements for any other buoy or parcel type. Decisions on buoy permits for private, single-family littoral parcels may be appealed to the Governing Board.

The Proposed amendment to Section 84.3.3.E.3:

- Authorize buoy fields for *non-littoral* HOAs possessing a valid permit issued by a federal or state agency with appropriate jurisdiction prior to September 1, 2018.

The proposed amendment to Section 2.2.2.F.2.b:

- allow mooring buoys associated with eligible private, single-family littoral parcels to be permitted at the staff-level with the option for appeal to the Governing Board.

On January 21, 2022, the Shoreline Steering Committee recommended amendments to Sections 84.3.3.E.3 and 2.2.2.F.2.b, as discussed in this staff packet. RPIC unanimously recommended the amendments on April 27, 2022. These amendments are intended to support the implementation of the Shoreline Plan's policies concerning the authorization of all legally preexisting buoy fields and allowances for mooring buoys on private, single-family littoral parcels.

Environmental Review:

TRPA staff completed an Initial Environmental Checklist (IEC) pursuant to Chapter 3: Environmental Documentation of the TRPA Code of Ordinances and Article VI of the Rules of Procedure. The IEC finds

that the proposed amendments would not result in significant effects on the environment (see Attachment C).

Regional Plan Compliance:

The proposed amendments to the Code of Ordinances are consistent with the Shorezone Sub-element, a component of the Regional Plan's Conservation Element, and with the Shoreline Plan.

Contact Information:

For questions regarding this agenda item, please contact Jacob Stock, at (775) 589-5221 or jstock@trpa.gov

Attachments:

- A. Adopting Ordinance
 - Exhibit 1: Tracked Code Amendments
- B. Required Findings/Rationale
- C. Initial Environmental Checklist (IEC)
- D. Compliance Measures Checklist

Attachment A
Adopting Ordinance

Attachment A

TAHOE REGIONAL PLANNING AGENCY ORDINANCE 2022-

AN AMENDMENT TO ORDINANCE NO. 87-9, AS AMENDED, TO AMEND THE TRPA CODE OF ORDINANCES, CHAPTERS 84 AND 2 REGARDING THE AUTHORIZATION OF EXISTING BUOY FIELDS AND ADMINISTRATIVE APPROVAL FOR NEW MOORING BUOYS ON ELIGIBLE PRIVATE, SINGLE-FAMILY LITTORAL PARCELS.

The Governing Board of the Tahoe Regional Planning Agency does ordain as follows:

Section 1.00 Findings

- 1.10 It is desirable to amend TRPA Ordinance 87-9, as previously amended, by amending the TRPA Code of Ordinances to further implement the Regional Plan pursuant to Article VI (a) and other provisions of the Tahoe Planning Compact.
- 1.20 The TRPA Code of Ordinances Chapter 61.1 amendments were the subject of an Initial Environmental Checklist (IEC), which was processed in accordance with Chapter 3: *Environmental Documentation* of the TRPA Code of Ordinances and Article VI of the Rules of Procedure. The TRPA Code of Ordinances amendments have been determined not to have a significant effect on the environment and are therefore exempt from the requirement of an Environmental Impact Statement (EIS) pursuant to Article VII of the Compact.
- 1.30 The Advisory Planning Commission (APC) and Governing Board have each conducted a noticed public hearing on the proposed TRPA Code of Ordinances Chapters 84 and 2 amendments. The APC has recommended Governing Board adoption of the necessary findings and adopting ordinance. At these hearings, oral testimony and documentary evidence were received and considered.
- 1.40 The Governing Board finds that the TRPA Code of Ordinances amendments adopted hereby will continue to implement the Regional Plan, as amended, in a manner that achieves and maintains the adopted environmental threshold carrying capacities as required by Article V (c) of the Compact.
- 1.50 Prior to the adoption of this ordinance, the Governing Board made findings required by Section 4.6 of the TRPA Code of Ordinances, and Article V (g) of the Compact.
- 1.60 Each of the foregoing findings is supported by substantial evidence in the record.

Section 2.00 TRPA Code of Ordinances Amendments

Ordinance 87-9, as previously amended, is hereby amended by amending Chapters 84 and 2 of the TRPA Code of Ordinances, as set forth in Exhibit 1.

Section 3.00 Interpretation and Severability

The provisions of this ordinance amending the TRPA Code of Ordinances adopted hereby shall be liberally construed to affect their purposes. If any section, clause, provision, or portion thereof is declared unconstitutional or invalid by a court of competent jurisdiction, the remainder of this ordinance and the amendments to the Regional Plan Package shall not be affected thereby. For this purpose, the provisions of this ordinance and the amendments to the Regional Plan Package are hereby declared respectively severable.

Section 4.00 Effective Date

The provisions of this ordinance amending the TRPA Code of Ordinances shall become effective sixty (60) days following adoption of this ordinance.

PASSED AND ADOPTED by the Governing Board of the Tahoe Regional Planning Agency at a regular meeting held on [DATE], 2022, by the following vote:

Ayes:

Nays:

Abstentions:

Absent:

Mark Bruce, Chair
Tahoe Regional Planning Agency,
Governing Board

EXHIBIT 1

PROPOSED AMENDMENTS

2.2.2 Projects and Matters to be Approved by the Governing Board or Hearings Officer

F. Shorezone Projects

1. Governing Board Review

Shorezone projects involving the following require review and approval by the Governing Board:

- a. Tour boat operations (new or expansion);
- b. Waterborne transit (new or expansion);
- c. Seaplane operation (new or expansion);
- d. Marinas (new or expansion);
- e. Boat launching facilities (new or expansion);
- f. Recognition of multiple-use facilities (Section **Error! Reference source not found.**); and

2. Hearings Officer

Shorezone projects involving the following require review and approval by the Hearings Officer:

- a. Special use projects (except those identified for Governing Board review) involving changes, expansions or intensifications of existing uses; and
- b. New structures (except those identified for Governing Board review [and new mooring buoys for eligible private, single-family littoral parcels](#)).

84.3.3 Mooring Buoys

E. Buoy Fields.

1. Eligibility.

- a. No additional buoy fields shall be permitted by TRPA.
- b. The total number of homeowners association mooring structures, including buoys within buoy fields, shall not exceed the total number of residential units served by the association.
- c. The total number of buoys allowed within a buoy field shall not exceed the buoy field capacity. The maximum buoy field area, for the purposes of determining capacity, is the length of the littoral property's lake frontage multiplied by a width of 300 feet (Figure 84.3.3-2). The capacity within the calculated buoy field area shall be limited by a 50-foot grid spacing pattern.

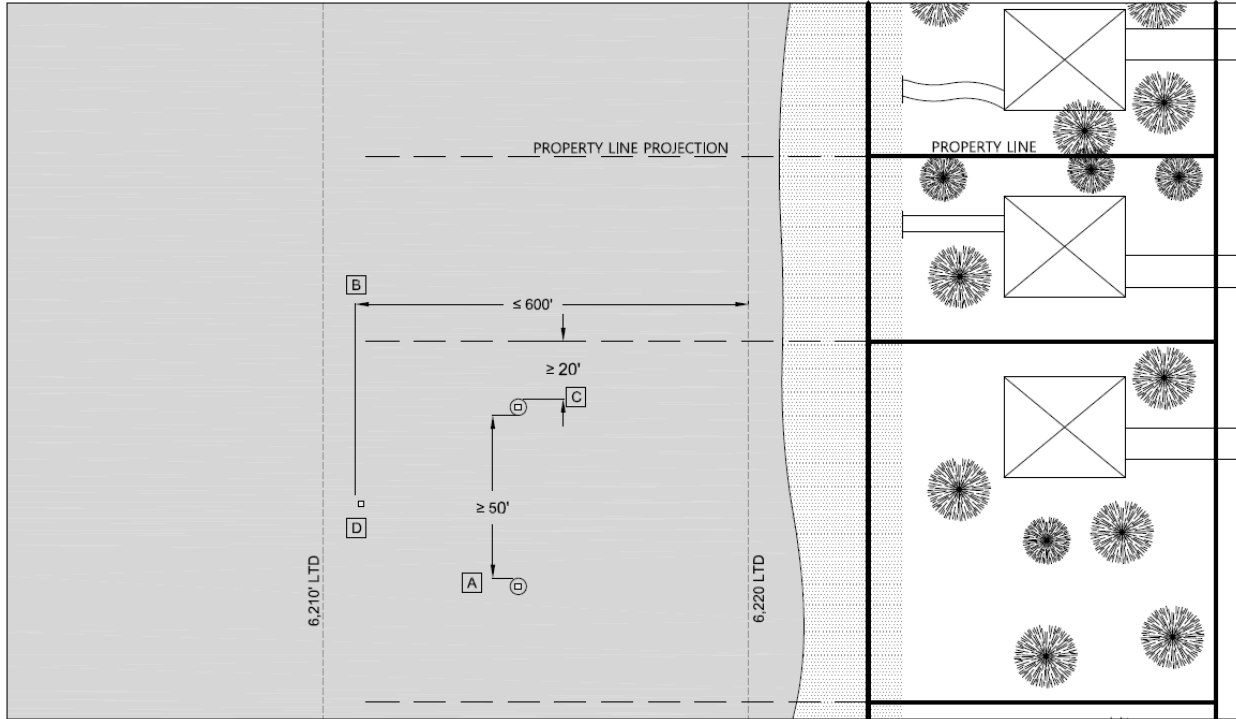

- A) BUOYS SHALL BE AT LEAST 50' FROM ANOTHER MOORING BUOY
- B) BUOYS SHALL BE NO GREATER THAN 600' LAKEWARD FROM 6,220 LTD, OR NO FARTHER LAKEWARD THAN 6,210 LTD, WHICHEVER IS LESS
- C) BUOYS SHALL BE AT LEAST 20' FROM LITTORAL PARCEL BOUNDARY PROJECTION LINES
- D) THERE SHALL BE NO MORE THAN 2 MOORINGS BUOYS PER PARCEL, HOWEVER A SINGLE ADDITIONAL BUOY BLOCK IS PERMITTED FOR USE IN LOW-WATER CONDITIONS

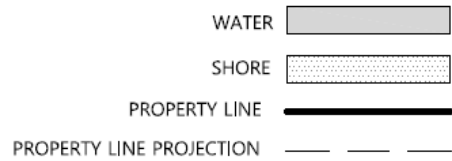

Figure 84.3.3-1. Mooring Buoy Location Standards

2. **Development Standards.** The following provisions apply to additional buoys in legally existing buoy fields. TRPA may allow deviation from these standards based on site-specific conditions, including neighboring uses and structures; State agency compliance; Coast Guard consultation; navigation; substrate, including obstacles; or bathymetry. Buoy fields associated with marinas are also subject to the provisions of subsection 84.6.3.C of this Chapter.
 - a. Buoys within a buoy field shall be located at least 50 feet from all legally existing buoys (50-foot grid spacing);
 - b. Buoys within a buoy field shall be located no greater than 600 feet lakeward from elevation 6,220 feet Lake Tahoe Datum, as measured horizontally; and
 - c. Buoys within a buoy field shall be located at least 20 feet from adjacent littoral parcel boundary projection lines.
3. **Existing Buoys [in a Buoy Field](#).**
 - a) TRPA may authorize existing mooring buoys offshore of a littoral parcel associated with a homeowners association or similar entity, commercial, tourist accommodation, marina, or public use, providing:
 - i. The littoral parcel owner provides a valid buoy permit issued by a federal or state agency with appropriate jurisdiction prior to September 1, 2018; or
 - ii. The littoral parcel owner provides clear evidence of the existence of the buoy(s) prior to February 10, 1972.
 - b) [TRPA may authorize existing mooring buoys associated with a non-littoral homeowner's association or similar entity within the Lake Tahoe region, providing the association provides a valid buoy permit issued by a federal or state agency with appropriate jurisdiction prior to September 1, 2018.](#)

Attachment B

Required Findings/Rationale

ATTACHMENT B
REQUIRED FINDINGS / RATIONALE

TRPA Code of Ordinances Section 3.3—Determination of Need to Prepare an Environmental Impact Statement

Finding: TRPA finds the proposed Code amendments will not have a significant effect on the environment.

Rationale: An Initial Environmental Checklist (IEC) was prepared to evaluate the effects of the proposed amendments to the Code of Ordinances (see Attachment C). The IEC found that the proposed Code amendments would not have a significant effect on the environment.

The proposed amendments are consistent with and will implement Chapter 84 Development Standards Lakeward of High Water in the Shorezone and Lakezone. The amendments are not anticipated to result in significant environmental effects. As demonstrated in the accompanying findings, amendments to Chapter 84 and 2 will not result in a significant impact on the environment or cause the environmental threshold carrying capacities to be exceeded.

TRPA Code of Ordinances Section 4.4—Threshold-Related Findings

1. Finding: The amendments to the Code of Ordinances are consistent with and will not adversely affect implementation of the Regional Plan, including all applicable Goals and Policies, plan area statements and maps, the Code, and other TRPA plans and programs;

Rationale: The proposed code amendments will not have significant environmental impacts and will improve TRPA’s ability to implement the Shoreline Plan and Chapter 84 Development Standards Lakeward of High Water in the Shorezone and Lakezone. The Code amendments are consistent with the Regional Plan policies and goals and all implementing elements of the Regional Plan.

2. Finding: The proposed amendments will not cause the environmental threshold carrying capacities to be exceeded; and

Rationale: The proposed amendments are consistent with the threshold attainment strategies in the Regional Plan. As demonstrated in the findings, these amendments will not cause the environmental threshold carrying capacities to be exceeded.

3. Finding: Wherever federal, state, or local air and water quality standards apply for the region, the strictest standards shall be attained, maintained, or exceeded pursuant to Article V(d) of the Tahoe Regional Planning Compact.

Rationale: The proposed amendments would not exceed any state, federal, or local standards. The amendments are intended to authorize existing buoy fields and to streamline the permitting process for buoys associated with private, single-family littoral parcels. The amendments will not result in environmental impacts and will remove an unnecessary burden from the Hearings Officer's schedule which can be directed to evaluating more complex projects with greater potential environmental impact.

TRPA Code of Ordinances Section 4.6—findings Necessary to Amend or Adopt TRPA Ordinances, Rules, or Other TRPA Plans and Programs.

Finding: The Regional Plan and all of its elements, as implemented through the Code, Rules, and other TRPA plans and programs, as amended, achieves and maintains thresholds.

Rationale: As discussed in Sections 4.4 and 4.5 above, the Regional Plan and all of its elements, as amended, achieves and maintains thresholds. The proposed amendments will support and improve implementation of the Shoreline Plan and Chapter 84 of the TRPA Code of Ordinances.

Attachment C

Initial Environmental Checklist (IEC)



**TAHOE
REGIONAL
PLANNING
AGENCY**

Mail

PO Box 5310
Stateline, NV 89449-5310

Location

128 Market Street
Stateline, NV 89449

Contact

Phone: 775-588-4547
Fax: 775-588-4527
www.trpa.gov

***INITIAL ENVIRONMENTAL CHECKLIST
FOR DETERMINATION OF ENVIRONMENTAL IMPACT***

Project Name:

APN/Project Location:

County/City:

Project Description:



Mail
 PO Box 5310
 Stateline, NV 89449-5310

Location
 128 Market Street
 Stateline, NV 89449

Contact
 Phone: 775-588-4547
 Fax: 775-588-4527
 www.trpa.gov

The following questionnaire will be completed by the applicant based on evidence submitted with the application. All "Yes" and "No, With Mitigation" answers will require further written comments. Use the blank boxes to add any additional information and reference the question number and letter. If more space is required for additional information, please attached separate sheets and reference the question number and letter.

For information on the status of TRPA environmental thresholds click on the links to the Threshold Dashboard.

I. Environmental Impacts

1. Land

Current and historic status of soil conservation standards can be found at the links below:

- [Impervious Cover](#)
- [Stream Environment Zone](#)

Will the proposal result in:

	Yes	No	No, with mitigation	Data insufficient
a. Compaction or covering of the soil beyond the limits allowed in the land capability or Individual Parcel Evaluation System (IPES)?	<input type="checkbox"/>	<input type="checkbox"/>	<input type="checkbox"/>	<input type="checkbox"/>
b. A change in the topography or ground surface relief features of site inconsistent with the natural surrounding conditions?	<input type="checkbox"/>	<input type="checkbox"/>	<input type="checkbox"/>	<input type="checkbox"/>
c. Unstable soil conditions during or after completion of the proposal?	<input type="checkbox"/>	<input type="checkbox"/>	<input type="checkbox"/>	<input type="checkbox"/>
d. Changes in the undisturbed soil or native geologic substructures or grading in excess of 5 feet?	<input type="checkbox"/>	<input type="checkbox"/>	<input type="checkbox"/>	<input type="checkbox"/>
e. The continuation of or increase in wind or water erosion of soils, either on or off the site?	<input type="checkbox"/>	<input type="checkbox"/>	<input type="checkbox"/>	<input type="checkbox"/>
f. Changes in deposition or erosion of beach sand, or changes in siltation, deposition or erosion, including natural littoral processes, which may modify the channel of a river or stream or the bed of a lake?	<input type="checkbox"/>	<input type="checkbox"/>	<input type="checkbox"/>	<input type="checkbox"/>
g. Exposure of people or property to geologic hazards such as earthquakes, landslides, backshore erosion, avalanches, mud slides, ground failure, or similar hazards?	<input type="checkbox"/>	<input type="checkbox"/>	<input type="checkbox"/>	<input type="checkbox"/>

Discussion



2. Air Quality

Current and historic status of air quality standards can be found at the links below:

- [Carbon Monoxide \(CO\)](#)
- [Nitrate Deposition](#)
- [Ozone \(O3\)](#)
- [Regional Visibility](#)
- [Respirable and Fine Particulate Matter](#)
- [Sub-Regional Visibility](#)

Will the proposal result in:

	Yes	No	No, with mitigation	Data insufficient
a. Substantial air pollutant emissions?	<input type="checkbox"/>	<input type="checkbox"/>	<input type="checkbox"/>	<input type="checkbox"/>
b. Deterioration of ambient (existing) air quality?	<input type="checkbox"/>	<input type="checkbox"/>	<input type="checkbox"/>	<input type="checkbox"/>
c. The creation of objectionable odors?	<input type="checkbox"/>	<input type="checkbox"/>	<input type="checkbox"/>	<input type="checkbox"/>
d. Alteration of air movement, moisture or temperature, or any change in climate, either locally or regionally?	<input type="checkbox"/>	<input type="checkbox"/>	<input type="checkbox"/>	<input type="checkbox"/>
e. Increased use of diesel fuel?	<input type="checkbox"/>	<input type="checkbox"/>	<input type="checkbox"/>	<input type="checkbox"/>

Discussion



3. Water Quality

Current and historic status of water quality standards can be found at the links below:

- [Aquatic Invasive Species](#)
- [Deep Water \(Pelagic\) Lake Tahoe](#)
- [Groundwater](#)
- [Nearshore \(Littoral\) Lake Tahoe](#)
- [Other Lakes](#)
- [Surface Runoff](#)
- [Tributaries](#)
- [Load Reductions](#)

Will the proposal result in:	Yes	No	No, with mitigation	Data insufficient
a. Changes in currents, or the course or direction of water movements?	<input type="checkbox"/>	<input type="checkbox"/>	<input type="checkbox"/>	<input type="checkbox"/>
b. Changes in absorption rates, drainage patterns, or the rate and amount of surface water runoff so that a 20 yr. 1 hr. storm runoff (approximately 1 inch per hour) cannot be contained on the site?	<input type="checkbox"/>	<input type="checkbox"/>	<input type="checkbox"/>	<input type="checkbox"/>
c. Alterations to the course or flow of 100-year flood waters?	<input type="checkbox"/>	<input type="checkbox"/>	<input type="checkbox"/>	<input type="checkbox"/>
d. Change in the amount of surface water in any water body?	<input type="checkbox"/>	<input type="checkbox"/>	<input type="checkbox"/>	<input type="checkbox"/>
e. Discharge into surface waters, or in any alteration of surface water quality, including but not limited to temperature, dissolved oxygen or turbidity?	<input type="checkbox"/>	<input type="checkbox"/>	<input type="checkbox"/>	<input type="checkbox"/>
f. Alteration of the direction or rate of flow of ground water?	<input type="checkbox"/>	<input type="checkbox"/>	<input type="checkbox"/>	<input type="checkbox"/>
g. Change in the quantity of groundwater, either through direct additions or withdrawals, or through interception of an aquifer by cuts or excavations?	<input type="checkbox"/>	<input type="checkbox"/>	<input type="checkbox"/>	<input type="checkbox"/>
h. Substantial reduction in the amount of water otherwise available for public water supplies?	<input type="checkbox"/>	<input type="checkbox"/>	<input type="checkbox"/>	<input type="checkbox"/>
i. Exposure of people or property to water related hazards such as flooding and/or wave action from 100-year storm occurrence or seiches?	<input type="checkbox"/>	<input type="checkbox"/>	<input type="checkbox"/>	<input type="checkbox"/>
j. The potential discharge of contaminants to the groundwater or any alteration of groundwater quality?	<input type="checkbox"/>	<input type="checkbox"/>	<input type="checkbox"/>	<input type="checkbox"/>
k. Is the project located within 600 feet of a drinking water source?	<input type="checkbox"/>	<input type="checkbox"/>	<input type="checkbox"/>	<input type="checkbox"/>

Discussion



Mail
 PO Box 5310
 Stateline, NV 89449-5310

Location
 128 Market Street
 Stateline, NV 89449

Contact
 Phone: 775-588-4547
 Fax: 775-588-4527
 www.trpa.gov

4. Vegetation

Current and historic status of vegetation preservation standards can be found at the links below:

- [Common Vegetation](#)
- [Late Seral/Old Growth Ecosystems](#)
- [Sensitive Plants](#)
- [Uncommon Plant Communities](#)

Will the proposal result in:	Yes	No	No, with mitigation	Data insufficient
a. Removal of native vegetation in excess of the area utilized for the actual development permitted by the land capability/IPES system?	<input type="checkbox"/>	<input type="checkbox"/>	<input type="checkbox"/>	<input type="checkbox"/>
b. Removal of riparian vegetation or other vegetation associated with critical wildlife habitat, either through direct removal or indirect lowering of the groundwater table?	<input type="checkbox"/>	<input type="checkbox"/>	<input type="checkbox"/>	<input type="checkbox"/>
c. Introduction of new vegetation that will require excessive fertilizer or water, or will provide a barrier to the normal replenishment of existing species?	<input type="checkbox"/>	<input type="checkbox"/>	<input type="checkbox"/>	<input type="checkbox"/>
d. Change in the diversity or distribution of species, or number of any species of plants (including trees, shrubs, grass, crops, micro flora, and aquatic plants)?	<input type="checkbox"/>	<input type="checkbox"/>	<input type="checkbox"/>	<input type="checkbox"/>
e. Reduction of the numbers of any unique, rare, or endangered species of plants?	<input type="checkbox"/>	<input type="checkbox"/>	<input type="checkbox"/>	<input type="checkbox"/>
f. Removal of stream bank and/or backshore vegetation, including woody vegetation such as willows?	<input type="checkbox"/>	<input type="checkbox"/>	<input type="checkbox"/>	<input type="checkbox"/>
g. Removal of any native live, dead or dying trees 30 inches or greater in diameter at breast height (dbh) within TRPA's Conservation or Recreation land use classifications?	<input type="checkbox"/>	<input type="checkbox"/>	<input type="checkbox"/>	<input type="checkbox"/>
h. A change in the natural functioning of an old growth ecosystem?	<input type="checkbox"/>	<input type="checkbox"/>	<input type="checkbox"/>	<input type="checkbox"/>

Discussion



Mail
 PO Box 5310
 Stateline, NV 89449-5310

Location
 128 Market Street
 Stateline, NV 89449

Contact
 Phone: 775-588-4547
 Fax: 775-588-4527
 www.trpa.gov

5. Wildlife

Current and historic status of special interest species standards can be found at the links below:

- [Special Interest Species](#)

Current and historic status of the fisheries standards can be found at the links below:

- [Instream Flow](#)
- [Lake Habitat](#)
- [Stream Habitat](#)

Will the proposal result in:

	Yes	No	No, with mitigation	Data insufficient
a. Change in the diversity or distribution of species, or numbers of any species of animals (birds, land animals including reptiles, fish and shellfish, benthic organisms, insects, mammals, amphibians or microfauna)?	<input type="checkbox"/>	<input type="checkbox"/>	<input type="checkbox"/>	<input type="checkbox"/>
b. Reduction of the number of any unique, rare or endangered species of animals?	<input type="checkbox"/>	<input type="checkbox"/>	<input type="checkbox"/>	<input type="checkbox"/>
c. Introduction of new species of animals into an area, or result in a barrier to the migration or movement of animals?	<input type="checkbox"/>	<input type="checkbox"/>	<input type="checkbox"/>	<input type="checkbox"/>
d. Deterioration of existing fish or wildlife habitat quantity or quality?	<input type="checkbox"/>	<input type="checkbox"/>	<input type="checkbox"/>	<input type="checkbox"/>

Discussion

6. Noise

Current and historic status of the noise standards can be found at the links below:

- [Cumulative Noise Events](#)
- [Single Noise Events](#)

Will the proposal result in:

	Yes	No	No, with mitigation	Data insufficient
a. Increases in existing Community Noise Equivalency Levels (CNEL) beyond those permitted in the applicable Area Plan, Plan Area Statement, Community Plan or Master Plan?	<input type="checkbox"/>	<input type="checkbox"/>	<input type="checkbox"/>	<input type="checkbox"/>
b. Exposure of people to severe noise levels?	<input type="checkbox"/>	<input type="checkbox"/>	<input type="checkbox"/>	<input type="checkbox"/>
c. Single event noise levels greater than those set forth in the TRPA Noise Environmental Threshold?	<input type="checkbox"/>	<input type="checkbox"/>	<input type="checkbox"/>	<input type="checkbox"/>
d. The placement of residential or tourist accommodation uses in areas where the existing CNEL exceeds 60 dBA or is otherwise incompatible?	<input type="checkbox"/>	<input type="checkbox"/>	<input type="checkbox"/>	<input type="checkbox"/>
e. The placement of uses that would generate an incompatible noise level in close proximity to existing residential or tourist accommodation uses?	<input type="checkbox"/>	<input type="checkbox"/>	<input type="checkbox"/>	<input type="checkbox"/>
f. Exposure of existing structures to levels of ground vibration that could result in structural damage?	<input type="checkbox"/>	<input type="checkbox"/>	<input type="checkbox"/>	<input type="checkbox"/>

Discussion



Mail
 PO Box 5310
 Stateline, NV 89449-5310

Location
 128 Market Street
 Stateline, NV 89449

Contact
 Phone: 775-588-4547
 Fax: 775-588-4527
 www.trpa.gov

7. Light and Glare

Will the proposal:

	Yes	No	No, with mitigation	Data insufficient
a. Include new or modified sources of exterior lighting?	<input type="checkbox"/>	<input type="checkbox"/>	<input type="checkbox"/>	<input type="checkbox"/>
b. Create new illumination which is more substantial than other lighting, if any, within the surrounding area?	<input type="checkbox"/>	<input type="checkbox"/>	<input type="checkbox"/>	<input type="checkbox"/>
c. Cause light from exterior sources to be cast off -site or onto public lands?	<input type="checkbox"/>	<input type="checkbox"/>	<input type="checkbox"/>	<input type="checkbox"/>
d. Create new sources of glare through the siting of the improvements or through the use of reflective materials?	<input type="checkbox"/>	<input type="checkbox"/>	<input type="checkbox"/>	<input type="checkbox"/>

Discussion

8. Land Use

Will the proposal:

	Yes	No	No, with mitigation	Data insufficient
a. Include uses which are not listed as permissible uses in the applicable Area Plan, Plan Area Statement, adopted Community Plan, or Master Plan?	<input type="checkbox"/>	<input type="checkbox"/>	<input type="checkbox"/>	<input type="checkbox"/>
b. Expand or intensify an existing non-conforming use?	<input type="checkbox"/>	<input type="checkbox"/>	<input type="checkbox"/>	<input type="checkbox"/>

Discussion



Mail
 PO Box 5310
 Stateline, NV 89449-5310

Location
 128 Market Street
 Stateline, NV 89449

Contact
 Phone: 775-588-4547
 Fax: 775-588-4527
 www.trpa.gov

9. Natural Resources

Will the proposal result in:

	Yes	No	No, with mitigation	Data insufficient
a. A substantial increase in the rate of use of any natural resources?	<input type="checkbox"/>	<input type="checkbox"/>	<input type="checkbox"/>	<input type="checkbox"/>
b. Substantial depletion of any non-renewable natural resource?	<input type="checkbox"/>	<input type="checkbox"/>	<input type="checkbox"/>	<input type="checkbox"/>

Discussion

10. Risk of Upset

Will the proposal:

	Yes	No	No, with mitigation	Data insufficient
a. Involve a risk of an explosion or the release of hazardous substances including, but not limited to, oil, pesticides, chemicals, or radiation in the event of an accident or upset conditions?	<input type="checkbox"/>	<input type="checkbox"/>	<input type="checkbox"/>	<input type="checkbox"/>
b. Involve possible interference with an emergency evacuation plan?	<input type="checkbox"/>	<input type="checkbox"/>	<input type="checkbox"/>	<input type="checkbox"/>

Discussion



Mail
 PO Box 5310
 Stateline, NV 89449-5310

Location
 128 Market Street
 Stateline, NV 89449

Contact
 Phone: 775-588-4547
 Fax: 775-588-4527
 www.trpa.gov

11. Population

Will the proposal:

	Yes	No	No, with mitigation	Data insufficient
a. Alter the location, distribution, density, or growth rate of the human population planned for the Region?	<input type="checkbox"/>	<input type="checkbox"/>	<input type="checkbox"/>	<input type="checkbox"/>
b. Include or result in the temporary or permanent displacement of residents?	<input type="checkbox"/>	<input type="checkbox"/>	<input type="checkbox"/>	<input type="checkbox"/>

Discussion

12. Housing

Will the proposal:

	Yes	No	No, with mitigation	Data insufficient
a. Affect existing housing, or create a demand for additional housing? <i>To determine if the proposal will affect existing housing or create a demand for additional housing, please answer the following questions:</i>				
1. Will the proposal decrease the amount of housing in the Tahoe Region?	<input type="checkbox"/>	<input type="checkbox"/>	<input type="checkbox"/>	<input type="checkbox"/>
2. Will the proposal decrease the amount of housing in the Tahoe Region historically or currently being rented at rates affordable by lower and very-low-income households?	<input type="checkbox"/>	<input type="checkbox"/>	<input type="checkbox"/>	<input type="checkbox"/>

Discussion



Mail
 PO Box 5310
 Stateline, NV 89449-5310

Location
 128 Market Street
 Stateline, NV 89449

Contact
 Phone: 775-588-4547
 Fax: 775-588-4527
 www.trpa.gov

13. Transportation / Circulation

Will the proposal result in:

	Yes	No	No, with mitigation	Data insufficient
a. Generation of 650 or more new average daily Vehicle Miles Travelled?	<input type="checkbox"/>	<input type="checkbox"/>	<input type="checkbox"/>	<input type="checkbox"/>
b. Changes to existing parking facilities, or demand for new parking?	<input type="checkbox"/>	<input type="checkbox"/>	<input type="checkbox"/>	<input type="checkbox"/>
c. Substantial impact upon existing transportation systems, including highway, transit, bicycle or pedestrian facilities?	<input type="checkbox"/>	<input type="checkbox"/>	<input type="checkbox"/>	<input type="checkbox"/>
d. Alterations to present patterns of circulation or movement of people and/or goods?	<input type="checkbox"/>	<input type="checkbox"/>	<input type="checkbox"/>	<input type="checkbox"/>
e. Alterations to waterborne, rail or air traffic?	<input type="checkbox"/>	<input type="checkbox"/>	<input type="checkbox"/>	<input type="checkbox"/>
f. Increase in traffic hazards to motor vehicles, bicyclists, or pedestrians?	<input type="checkbox"/>	<input type="checkbox"/>	<input type="checkbox"/>	<input type="checkbox"/>

Discussion



Mail
 PO Box 5310
 Stateline, NV 89449-5310

Location
 128 Market Street
 Stateline, NV 89449

Contact
 Phone: 775-588-4547
 Fax: 775-588-4527
 www.trpa.gov

14. Public Services

Will the proposal have an unplanned effect upon, or result in a need for new or altered governmental services in any of the following areas?:

	Yes	No	No, with mitigation	Data insufficient
a. Fire protection?	<input type="checkbox"/>	<input type="checkbox"/>	<input type="checkbox"/>	<input type="checkbox"/>
b. Police protection?	<input type="checkbox"/>	<input type="checkbox"/>	<input type="checkbox"/>	<input type="checkbox"/>
c. Schools?	<input type="checkbox"/>	<input type="checkbox"/>	<input type="checkbox"/>	<input type="checkbox"/>
d. Parks or other recreational facilities?	<input type="checkbox"/>	<input type="checkbox"/>	<input type="checkbox"/>	<input type="checkbox"/>
e. Maintenance of public facilities, including roads?	<input type="checkbox"/>	<input type="checkbox"/>	<input type="checkbox"/>	<input type="checkbox"/>
f. Other governmental services?	<input type="checkbox"/>	<input type="checkbox"/>	<input type="checkbox"/>	<input type="checkbox"/>

Discussion



Mail
 PO Box 5310
 Stateline, NV 89449-5310

Location
 128 Market Street
 Stateline, NV 89449

Contact
 Phone: 775-588-4547
 Fax: 775-588-4527
 www.trpa.gov

15. Energy

Will the proposal result in:

	Yes	No	No, with mitigation	Data insufficient
a. Use of substantial amounts of fuel or energy?	<input type="checkbox"/>	<input type="checkbox"/>	<input type="checkbox"/>	<input type="checkbox"/>
b. Substantial increase in demand upon existing sources of energy, or require the development of new sources of energy?	<input type="checkbox"/>	<input type="checkbox"/>	<input type="checkbox"/>	<input type="checkbox"/>

Discussion:

16. Utilities

Except for planned improvements, will the proposal result in a need for new systems, or substantial alterations to the following utilities:

	Yes	No	No, with mitigation	Data insufficient
a. Power or natural gas?	<input type="checkbox"/>	<input type="checkbox"/>	<input type="checkbox"/>	<input type="checkbox"/>
b. Communication systems?	<input type="checkbox"/>	<input type="checkbox"/>	<input type="checkbox"/>	<input type="checkbox"/>
c. Utilize additional water which amount will exceed the maximum permitted capacity of the service provider?	<input type="checkbox"/>	<input type="checkbox"/>	<input type="checkbox"/>	<input type="checkbox"/>
d. Utilize additional sewage treatment capacity which amount will exceed the maximum permitted capacity of the sewage treatment provider?	<input type="checkbox"/>	<input type="checkbox"/>	<input type="checkbox"/>	<input type="checkbox"/>
e. Storm water drainage?	<input type="checkbox"/>	<input type="checkbox"/>	<input type="checkbox"/>	<input type="checkbox"/>
f. Solid waste and disposal?	<input type="checkbox"/>	<input type="checkbox"/>	<input type="checkbox"/>	<input type="checkbox"/>

Discussion



Mail
 PO Box 5310
 Stateline, NV 89449-5310

Location
 128 Market Street
 Stateline, NV 89449

Contact
 Phone: 775-588-4547
 Fax: 775-588-4527
 www.trpa.gov

17. Human Health

Will the proposal result in:

	Yes	No	No, with mitigation	Data insufficient
a. Creation of any health hazard or potential health hazard (excluding mental health)?	<input type="checkbox"/>	<input type="checkbox"/>	<input type="checkbox"/>	<input type="checkbox"/>
b. Exposure of people to potential health hazards?	<input type="checkbox"/>	<input type="checkbox"/>	<input type="checkbox"/>	<input type="checkbox"/>

Discussion

18. Scenic Resources / Community Design

Current and historic status of the scenic resources standards can be found at the links below:

- [Built Environment](#)
- [Other Areas](#)
- [Roadway and Shoreline Units](#)

Will the proposal:

	Yes	No	No, with mitigation	Data insufficient
a. Be visible from any state or federal highway, Pioneer Trail or from Lake Tahoe?	<input type="checkbox"/>	<input type="checkbox"/>	<input type="checkbox"/>	<input type="checkbox"/>
b. Be visible from any public recreation area or TRPA designated bicycle trail?	<input type="checkbox"/>	<input type="checkbox"/>	<input type="checkbox"/>	<input type="checkbox"/>
c. Block or modify an existing view of Lake Tahoe or other scenic vista seen from a public road or other public area?	<input type="checkbox"/>	<input type="checkbox"/>	<input type="checkbox"/>	<input type="checkbox"/>
d. Be inconsistent with the height and design standards required by the applicable ordinance, Community Plan, or Area Plan?	<input type="checkbox"/>	<input type="checkbox"/>	<input type="checkbox"/>	<input type="checkbox"/>
e. Be inconsistent with the TRPA Scenic Quality Improvement Program (SQIP) or Design Review Guidelines?	<input type="checkbox"/>	<input type="checkbox"/>	<input type="checkbox"/>	<input type="checkbox"/>

Discussion



Mail
 PO Box 5310
 Stateline, NV 89449-5310

Location
 128 Market Street
 Stateline, NV 89449

Contact
 Phone: 775-588-4547
 Fax: 775-588-4527
 www.trpa.gov

19. Recreation

Current and historic status of the recreation standards can be found at the links below:

- [Fair Share Distribution of Recreation Capacity](#)
- [Quality of Recreation Experience and Access to Recreational Opportunities](#)

Will the proposal:

	Yes	No	No, with mitigation	Data insufficient
a. Create additional demand for recreation facilities?	<input type="checkbox"/>	<input type="checkbox"/>	<input type="checkbox"/>	<input type="checkbox"/>
b. Create additional recreation capacity?	<input type="checkbox"/>	<input type="checkbox"/>	<input type="checkbox"/>	<input type="checkbox"/>
c. Have the potential to create conflicts between recreation uses, either existing or proposed?	<input type="checkbox"/>	<input type="checkbox"/>	<input type="checkbox"/>	<input type="checkbox"/>
d. Result in a decrease or loss of public access to any lake, waterway, or public lands?	<input type="checkbox"/>	<input type="checkbox"/>	<input type="checkbox"/>	<input type="checkbox"/>

Discussion



Mail
 PO Box 5310
 Stateline, NV 89449-5310

Location
 128 Market Street
 Stateline, NV 89449

Contact
 Phone: 775-588-4547
 Fax: 775-588-4527
 www.trpa.gov

20. Archaeological / Historical

Will the proposal result in:

	Yes	No	No, with mitigation	Data insufficient
a. An alteration of or adverse physical or aesthetic effect to a significant archaeological or historical site, structure, object or building?	<input type="checkbox"/>	<input type="checkbox"/>	<input type="checkbox"/>	<input type="checkbox"/>
b. Is the proposed project located on a property with any known cultural, historical, and/or archaeological resources, including resources on TRPA or other regulatory official maps or records?	<input type="checkbox"/>	<input type="checkbox"/>	<input type="checkbox"/>	<input type="checkbox"/>
c. Is the property associated with any historically significant events and/or sites or persons?	<input type="checkbox"/>	<input type="checkbox"/>	<input type="checkbox"/>	<input type="checkbox"/>
d. Does the proposal have the potential to cause a physical change which would affect unique ethnic cultural values?	<input type="checkbox"/>	<input type="checkbox"/>	<input type="checkbox"/>	<input type="checkbox"/>
e. Will the proposal restrict historic or pre-historic religious or sacred uses within the potential impact area?	<input type="checkbox"/>	<input type="checkbox"/>	<input type="checkbox"/>	<input type="checkbox"/>

Discussion



Mail
 PO Box 5310
 Stateline, NV 89449-5310

Location
 128 Market Street
 Stateline, NV 89449

Contact
 Phone: 775-588-4547
 Fax: 775-588-4527
 www.trpa.gov

21. Findings of Significance

	Yes	No	No, with mitigation	Data insufficient
a. Does the project have the potential to degrade the quality of the environment, substantially reduce the habitat of a fish population to drop below self-sustaining levels, threaten to eliminate a plant or animal community, reduce the number or restrict the range of a rare or endangered plant or animal or eliminate important examples of the major periods of California or Nevada history or prehistory?	<input type="checkbox"/>	<input type="checkbox"/>	<input type="checkbox"/>	<input type="checkbox"/>
b. Does the project have the potential to achieve short-term, to the disadvantage of long-term, environmental goals? (A short-term impact on the environment is one which occurs in a relatively brief, definitive period of time, while long-term impacts will endure well into the future.)	<input type="checkbox"/>	<input type="checkbox"/>	<input type="checkbox"/>	<input type="checkbox"/>
c. Does the project have impacts which are individually limited, but cumulatively considerable? (A project may impact on two or more separate resources where the impact on each resource is relatively small, but where the effect of the total of those impacts on the environmental is significant?)	<input type="checkbox"/>	<input type="checkbox"/>	<input type="checkbox"/>	<input type="checkbox"/>
d. Does the project have environmental impacts which will cause substantial adverse effects on human being, either directly or indirectly?	<input type="checkbox"/>	<input type="checkbox"/>	<input type="checkbox"/>	<input type="checkbox"/>

Discussion



Mail
PO Box 5310
Stateline, NV 89449-5310

Location
128 Market Street
Stateline, NV 89449

Contact
Phone: 775-588-4547
Fax: 775-588-4527
www.trpa.gov

DECLARATION:

I hereby certify that the statements furnished above and in the attached exhibits present the data and information required for this initial evaluation to the best of my ability, and that the facts, statements, and information presented are true and correct to the best of my knowledge and belief.

Signature:

_____ at _____
Person preparing application County Date

Applicant Written Comments: (Attach additional sheets if necessary)



Mail
PO Box 5310
Stateline, NV 89449-5310

Location
128 Market Street
Stateline, NV 89449

Contact
Phone: 775-588-4547
Fax: 775-588-4527
www.trpa.gov

Determination:

On the basis of this evaluation:

- a. The proposed project could not have a significant effect on the environment and a finding of no significant effect shall be prepared in accordance with TRPA's Rules of Procedure YES NO
- b. The proposed project could have a significant effect on the environment, but due to the listed mitigation measures which have been added to the project, could have no significant effect on the environment and a mitigated finding of no significant effect shall be prepared in accordance with TRPA's Rules and Procedures. YES NO
- c. The proposed project may have a significant effect on the environment and an environmental impact statement shall be prepared in accordance with this chapter and TRPA's Rules of Procedures. YES NO

Signature of Evaluator

Date _____

Title of Evaluator

Attachment D

Compliance Measures Checklist

ATTACHMENT D: COMPLIANCE MEASURES AFFECTED BY DRSI RECOMMENDATIONS

Tracking Number	Compliance Measure Description	Affected Threshold Categories	Affected by Action (Y/N)	Comments
WATER QUALITY/SEZ - IN PLACE				
1	BMP requirements, new development: <i>Code of Ordinances</i> Chapter 60	WQ, Soils/SEZ, Fish	N	The proposed amendment will not impact the BMP implementation program for water quality and SEZs.
2	BMP implementation program -- existing streets and highways: <i>Code of Ordinances</i> Chapter 60	WQ, Soils/SEZ, Trans, Fish	N	
3	BMP implementation program -- existing urban development: <i>Code of Ordinances</i> Chapter 60	WQ, Soils/SEZ, Fish	N	
4	BMP implementation program -- existing urban drainage systems: <i>Code of Ordinances</i> Chapter 60	WQ, Soils/SEZ, Trans, Fish	N	
5	Capital Improvements Program for Erosion and Runoff Control	WQ, Soils/SEZ, Trans, Fish	N	The proposed amendment will not impact capital improvements for erosion control.
6	Excess land coverage mitigation program: <i>Code of Ordinances</i> Chapter 30	WQ, Soils/SEZ	N	No impact to excess land management mitigation program
7	Effluent (Discharge) limitations: California (SWRCB, Lahontan Board) and Nevada (NDEP): <i>Code of Ordinances</i> Chapter 60	WQ, Soils/SEZ, Fish	N	No change to effluent discharge.
8	Limitations on new subdivisions: (See the Goals and Policies: Land Use Element)	WQ, Soils/SEZ, Rec, Scenic	N	No impact on subdivision limitation.

Tracking Number	Compliance Measure Description	Affected Threshold Categories	Affected by Action (Y/N)	Comments
9	Land use planning and controls: See the Goals and Policies: Land Use Element and Code of Ordinances Chapters 11, 12, 13, 14, and 21	WQ, Soils/SEZ, Trans, Scenic	N	The proposed amendment will not impact land use planning and controls.
10	Residential development priorities, The Individual Parcel Evaluation System (IPES): Goals and Policies: Implementation Element and Code of Ordinances Chapter 53	WQ, Soils/SEZ	N	No change to residential development priorities or IPES.
11	Limits on land coverage for new development: Goals and Policies: Land Use Element and Code of Ordinances Chapter 30	WQ, Soils/SEZ, Scenic	N	No change to land coverage limits.

Tracking Number	Compliance Measure Description	Affected Threshold Categories	Affected by Action (Y/N)	Comments
12	Transfer of development: Goals and Policies: Land Use Element and Implementation Element	WQ, Soils/SEZ	N	No impact on TDR program.
13	Restrictions on SEZ encroachment and vegetation alteration: <i>Code of Ordinances Chapters 30 and 61</i>	WQ, Soils/SEZ, Veg, Wildlife, Fish, Rec, Scenic	N	No change to restrictions on SEZ encroachment or vegetation alteration.
14	SEZ restoration program: Environmental Improvement Program.	WQ, Soils/SEZ, Veg, Wildlife, Fish, Scenic	N	No impact on SEZ restoration program.
15	SEZ setbacks: <i>Code of Ordinances Chapter 53</i>	WQ, Soils/SEZ, Veg, Wildlife, Fish	N	No change to SEZ setbacks.
16	Fertilizer reporting requirements: <i>Code of Ordinances Chapter 60</i>	WQ, Soils/SEZ, Fish, Rec	N	No impact on water quality mitigation or fertilizer reporting requirements.
17	Water quality mitigation: <i>Code of Ordinances Chapter 60</i>	WQ, Soils/SEZ	N	
18	Restrictions on rate and/or amount of additional development	WQ, Soils/SEZ, Wildlife, Scenic	N	No change to rate or amount of development.
19	Improved BMP implementation/enforcement program	WQ, Soils/SEZ	N	No change to BMP program.
20	Increased funding for EIP projects for erosion and runoff control	WQ, Soils/SEZ	N	The amendment will not impact funding for EIP projects.
21	Artificial wetlands/runoff treatment program	WQ, Soils/SEZ	N	No impact on artificial wetlands or runoff treatment program.

Tracking Number	Compliance Measure Description	Affected Threshold Categories	Affected by Action (Y/N)	Comments	
22	Transfer of development from SEZs	WQ, Soils/SEZ, Scenic	N	No transfer of development from an SEZ.	
23	Improved mass transportation	WQ, Trans, Noise	N	The proposed amendment does not impact mass transportation	
24	Redevelopment and redirection of land use: Goals and Policies: Land Use Element and Code of Ordinances Chapter 13	WQ, Soils/SEZ, Scenic	N	No impact on redevelopment or redirection of land use.	
25	Combustion heater rules, stationary source controls, and related rules: <i>Code of Ordinances</i> Chapter 65	WQ, AQ	N	The proposed amendment will not impact water quality, soil or SEZ protection measures related to utilities.	
26	Elimination of accidental sewage releases: Goals and Policies: Land Use Element	WQ, Soils/SEZ	N		
27	Reduction of sewer line exfiltration: Goals and Policies: Land Use Element	WQ, Soils/SEZ	N		
28	Effluent limitations	WQ, Soils/SEZ	N		
29	Regulation of wastewater disposal at sites not connected to sewers: <i>Code of Ordinances</i> Chapter 60	WQ, Soils/SEZ	N		
30	Prohibition on solid waste disposal: Goals and Policies: Land Use Element	WQ, Soils/SEZ	N		
31	Mandatory garbage pick-up: Goals and Policies: Public Service Element	WQ, Soils/SEZ, Wildlife	N		
32	Hazardous material/wastes programs: Goals and Policies: Land Use Element and Code of Ordinances Chapter 60	WQ, Soils/SEZ	N		
33	BMP implementation program, Snow and ice control practices: <i>Code of Ordinances</i> Chapter 60	WQ, Soils/SEZ, AQ	N		The proposed amendment will not impact water quality, soil or SEZ protection measures related to transportation, recreation, livestock, or pesticides.

Tracking Number	Compliance Measure Description	Affected Threshold Categories	Affected by Action (Y/N)	Comments
34	Reporting requirements, highway abrasives and deicers: Goals and Policies:, Land Use Element and Code of Ordinances Chapter 60	WQ, Soils/SEZ, Fish	N	
35	BMP implementation program--roads, trails, skidding, logging practices: <i>Code of Ordinances</i> Chapter 60, Chapter 61	WQ, Soils/SEZ, Fish	N	
36	BMP implementation program--outdoor recreation: <i>Code of Ordinances</i> Chapter 60	WQ, Soils/SEZ, Fish, Rec	N	
37	BMP implementation program--livestock confinement and grazing: <i>Code of Ordinances</i> Chapter 21, Chapter 60, Chapter 64	WQ, Soils/SEZ, Veg, Wildlife, Fish	N	
38	BMP implementation program--pesticides	WQ, Soils/SEZ	N	
39	Land use planning and controls -- timber harvesting: <i>Code of Ordinances</i> Chapter 21	WQ, Soils/SEZ, AQ, Wildlife, Fish, Scenic	N	No impact to land use planning controls.
40	Land use planning and controls - outdoor recreation: <i>Code of Ordinances</i> Chapter 21	WQ, Soils/SEZ, Wildlife, Noise, Rec, Scenic	N	
41	Land use planning and controls--ORV use: Goals and Policies: Recreation Element	WQ, Soils/SEZ, AQ, Wildlife, Fish, Noise, Rec, Scenic	s	No impact to land use planning controls.
42	Control of encroachment and coverage in sensitive areas	WQ, Soils/SEZ, Wildlife, Rec, Scenic	N	No change to control of encroachment and coverage in sensitive areas.
43	Control on shorezone encroachment and vegetation alteration: <i>Code of Ordinances</i> Chapter 83	WQ, Soils/SEZ, Scenic	N	The proposed amendment will authorize preexisting shorezone moorings, it will not make any new changes to existing programs.
44	BMP implementation program--shorezone areas: <i>Code of Ordinances</i> Chapter 60	WQ, Soils/SEZ	N	

Tracking Number	Compliance Measure Description	Affected Threshold Categories	Affected by Action (Y/N)	Comments
45	BMP implementation program--dredging and construction in Lake Tahoe: <i>Code of Ordinances</i> Chapter 60	WQ, Soils/SEZ	N	
46	Restrictions and conditions on filling and dredging: <i>Code of Ordinances</i> Chapter 84	WQ, Soils/SEZ, Fish	N	
47	Protection of stream deltas	WQ, Soils/SEZ, Wildlife, Fish, Scenic	N	
48	Marina master plans: <i>Code of Ordinances</i> Chapter 14	WQ, AQ/Trans, Fish, Scenic	N	
49	Additional pump-out facilities: <i>Code of Ordinances</i> Chapter 60	WQ, Soils/SEZ	N	
50	Controls on anti-fouling coatings: <i>Code of Ordinances</i> Chapter 60	WQ, Soils/SEZ, Fish	N	
51	Modifications to list of exempt activities	WQ, Soils/SEZ	N	N/A

WATER QUALITY/SEZ - SUPPLEMENTAL

52	More stringent SEZ encroachment rules	WQ, Soils/SEZ, Wildlife, Fish	N	The proposed amendment will not add or alter any restrictions, controls or programs.
53	More stringent coverage transfer requirements	WQ, Soils/SEZ	N	
54	Modifications to IPES	WQ, Soils/SEZ	N	
55	Increased idling restrictions	WQ, Soils/SEZ, AQ	N	
56	Control of upwind pollutants	WQ, Soils/SEZ, AQ	N	
57	Additional controls on combustion heaters	WQ, Soils/SEZ, AQ	N	
58	Improved exfiltration control program	WQ, Soils/SEZ	N	
59	Improved infiltration control program	WQ, Soils/SEZ	N	
60	Water conservation/flow reduction program	WQ, Soils/SEZ, Fish	N	
61	Additional land use controls	WQ, Soils/SEZ, Wildlife	N	

AIR QUALITY/TRANSPORTATION - IN PLACE

62	Fixed Route Transit	Trans, Rec	N	No impact to transportation services or facilities.

Tracking Number	Compliance Measure Description	Affected Threshold Categories	Affected by Action (Y/N)	Comments
64	Demand Responsive Transit	Trans	N	
65	Seasonal Transit Services	Trans, Rec	N	
66	Social Service Transportation	Trans	N	
67	Shuttle programs	Trans, Rec	N	
69	Intercity bus services	Trans	N	
70	Passenger Transit Facilities	Trans	N	
71	Bikeways, Bike Trails	Trans, Noise, Rec, Scenic	N	
72	Pedestrian facilities	Trans, Rec, Scenic	N	
73	Wood heater controls: <i>Code of Ordinances</i> Chapter 65	WQ, AQ	N	No change to air or water quality controls.
74	Gas heater controls: <i>Code of Ordinances</i> Chapter 65	WQ, AQ	N	
75	Stationary source controls: <i>Code of Ordinances</i> Chapter 65	WQ, AQ	N	
76	U.S. Postal Service Mail Delivery	Trans	N	No impact to mail service delivery.
77	Indirect source review/air quality mitigation: <i>Code of Ordinances</i> Chapter 65	WQ, AQ, Trans	N	No change to air or water quality controls.
78	Idling Restrictions: <i>Code of Ordinances</i> Chapter 65	WQ, AQ	N	
79	Vehicle Emission Limitations(State/Federal)	WQ, AQ	N	No change to vehicle emissions limitations.
80	Open Burning Controls: <i>Code of Ordinances</i> Chapters 61 and Chapter 65	WQ, AQ, Scenic	N	No change to burning controls.
81	BMP and Revegetation Practices	WQ, AQ, Wildlife, Fish	N	No impact on BMP or revegetation.
82	Employer-based Trip Reduction Programs: <i>Code of Ordinances</i> Chapter 65	Trans	N	No impact on employer-based trip reduction or vehicle rental programs.
83	Vehicle rental programs: <i>Code of Ordinances</i> Chapter 65	Trans	N	
84	Parking Standards	Trans	N	The proposed amendment will authorize existing mooring buoys.
85	Parking Management Areas	Trans	N	The amendment will not change or impact transportation facilities or programs including waterborne transportation.
86	Parking Fees	Trans	N	
87	Parking Facilities	Trans	N	
88	Traffic Management Program - Tahoe City	Trans	N	

Tracking Number	Compliance Measure Description	Affected Threshold Categories	Affected by Action (Y/N)	Comments
89	US 50 Traffic Signal Synchronization - South Shore	Trans	N	
90	General Aviation, The Lake Tahoe Airport	Trans, Noise	N	
91	Waterborne excursions	WQ, Trans, Rec	N	
92	Waterborne transit services	WQ, Trans, Scenic	N	
93	Air Quality Studies and Monitoring	WQ, AQ	N	
94	Alternate Fueled Vehicle - Public/Private Fleets and Infrastructure Improvements	Trans	N	
95	Demand Responsive Transit - North Shore	Trans	N	
96	Tahoe Area Regional Transit Maintenance Facility	Trans	N	
97	Heavenly Ski Resort Gondola	Trans	N	
AIR QUALITY/TRANSPORTATION - SUPPLEMENTAL				
98	Demand Responsive Transit –North Shore	Trans	N	The proposed amendment will authorize existing mooring buoys. The amendment will not change or impact transportation facilities or programs including waterborne transportation.
99	Coordinated Transit System - South Shore	Trans	N	
100	Transit Passenger Facilities	Trans	N	
101	South Shore Transit Maintenance Facility - South Shore	Trans	N	
102	Transit Service - Fallen Leaf Lake	WQ, Trans	N	
103	Transit Institutional Improvements	Trans	N	
104	Transit Capital and Operations Funding Acquisition	Trans	N	
105	Transit/Fixed Guideway Easements - South Shore	Trans	N	
106	Visitor Capture Program	Trans	N	
107	Pedestrian and Bicycle Facilities-- South Shore	Trans, Rec	N	
108	Pedestrian and Bicycle Facilities-- North Shore	Trans, Rec	N	
109	Parking Inventories and Studies Standards	Trans	N	
110	Parking Management Areas	Trans	N	
111	Parking Fees	Trans	N	
112	Establishment of Parking Task Force	Trans	N	
113	Construct parking facilities	Trans	N	
114	Intersection improvements--South Shore	Trans, Scenic	N	
115	Intersection improvements--North Shore	Trans, Scenic	N	
116	Roadway Improvements - South Shore	Trans, Scenic	N	

Tracking Number	Compliance Measure Description	Affected Threshold Categories	Affected by Action (Y/N)	Comments
117	Roadway Improvements - North Shore	Trans, Scenic	N	
118	Loop Road - South Shore	Trans, Scenic	N	
119	Montreal Road Extension	Trans	N	
120	Kingsbury Connector	Trans	N	
121	Commercial Air Service: Part 132 commercial air service	Trans	N	
122	Commercial Air Service: commercial air service that does not require Part 132 certifications	Trans	N	
123	Expansion of waterborne excursion service	WQ, Trans	N	
124	Re-instate the oxygenated fuel program	WQ, AQ	N	
125	Management Programs	Trans	N	
126	Around the Lake Transit	Trans	N	
VEGETATION - IN PLACE				
127	Vegetation Protection During Construction: <i>Code of Ordinances</i> Chapter 33	WQ, AQ, Veg, Scenic	N	No impact on vegetation protection.
128	Tree Removal: <i>Code of Ordinances</i> Chapter 61	Veg, Wildlife, Scenic	N	No impact to vegetation management.
129	Prescribed Burning: <i>Code of Ordinances</i> Chapter 61	WQ, AQ, Veg, Wildlife, Scenic	N	
130	Remedial Vegetation Management: <i>Code of Ordinances</i> Chapter 61	WQ, Veg, Wildlife	N	
131	Sensitive and Uncommon Plant Protection and Fire Hazard Reduction: <i>Code of Ordinances</i> Chapter 61	Veg, Wildlife, Scenic	N	
132	Revegetation: <i>Code of Ordinances</i> Chapter 61	WQ, Veg, Wildlife, Scenic	N	
133	Remedial Action Plans: <i>Code of Ordinances</i> Chapter 5	WQ, Veg	N	No change to remedial action plans.
134	Handbook of Best Management Practices	WQ, Soils/SEZ, Veg, Fish	N	No change to BMP handbook.
135	Shorezone protection	WQ, Soils/SEZ, Veg	N	The proposed amendment authorizes existing buoy fields and alters the review requirements for new single family buoys. It does not make any changes to shorezone protection including conformance requirements for new buoys.
136	Project Review	WQ, Veg	Y	The proposed amendment changes the permit review process for new single-family mooring buoys from Hearings Officer to staff-

Tracking Number	Compliance Measure Description	Affected Threshold Categories	Affected by Action (Y/N)	Comments
137	Compliance inspections	Veg	N	level. It does not change the compliance requirements for the issuance of a permit.
138	Development Standards in the Backshore	WQ, Soils/SEZ, Veg, Wildlife, Scenic	N	No change to development standards.
139	Land Coverage Standards: <i>Code of Ordinances</i> Chapter 30	WQ, Veg, Wildlife, Fish, Scenic	N	No change to land coverage standards.
140	Grass Lake, Research Natural Area	WQ, Veg, Wildlife, Fish, Scenic	N	The proposed amendment does not impact the Grass Lake Research Area.
141	Conservation Element, Vegetation Subelement: Goals and Policies	Veg, Wildlife, Fish	N	No change to the conservation element, vegetation subelement.
142	Late Successional Old Growth (LSOG): <i>Code of Ordinances</i> Chapter 61	Veg, Wildlife, Fish	N	No impact on LSOG or SEZ vegetation.
143	Stream Environment Zone Vegetation: <i>Code of Ordinances</i> Chapter 61	WQ, Veg, Wildlife, Fish	N	
144	Tahoe Yellow Cress Conservation Strategy	Veg	N	No impact on Tahoe Yellow Cress Conservation Strategy.
145	Control and/or Eliminate Noxious Weeds	Veg, Wildlife	N	No impact on noxious weed control or elimination.
146	Freel Peak Cushion Plant Community Protection	Veg	N	No impact to Freel Peak Cushion Plant protection.
VEGETATION - SUPPLEMENTAL				
147	Deepwater Plant Protection	WQ, Veg	N	No impact to deepwater plant protection.
WILDLIFE - IN PLACE				
148	Wildlife Resources: <i>Code of Ordinances</i> Chapter 62	Wildlife, Noise	N	No impact to wildlife resources.
149	Stream Restoration Program	WQ, Soils/SEZ, Veg, Wildlife, Fish, Rec, Scenic	N	No change to stream restoration program.
150	BMP and revegetation practices	WQ, Veg, Wildlife, Fish, Scenic	N	No impact to BMP or revegetation practices.
151	OHV limitations	WQ, Soils/SEZ, AQ, Wildlife, Noise, Rec	N	No change to OHV limitations.

Tracking Number	Compliance Measure Description	Affected Threshold Categories	Affected by Action (Y/N)	Comments
152	Remedial Action Plans: <i>Code of Ordinances</i> Chapter 5	Wildlife	N	No change to remedial action plans.
153	Project Review	Wildlife	Y	The proposed amendment changes the permit review process for new single-family mooring buoys from Hearings Officer to staff-

FISHERIES - IN PLACE

156	Fish Resources: <i>Code of Ordinances</i> Chapter 63	WQ, Fish	N	No impact on fish resources.
157	Tree Removal: <i>Code of Ordinances</i> Chapter 61	Wildlife, Fish	N	No impact on tree removal.
158	Shorezone BMPs	WQ, Fish	N	The proposed amendment will not make any changes to standards for new shorezone structures.
159	Filling and Dredging: <i>Code of Ordinances</i> Chapter 84	WQ, Fish	N	
160	Location standards for structures in the shorezone: <i>Code of Ordinances</i> Chapter 84	WQ, Fish	N	
161	Restrictions on SEZ encroachment and vegetation alteration	WQ, Soils/SEZ, Fish	N	No impact to SEZ encroachment or vegetation.
162	SEZ Restoration Program	WQ, Soils/SEZ, Fish	N	No change to SEZ restoration program.
163	Stream restoration program	WQ, Soils/SEZ, Fish	N	No impact on stream or riparian restoration programs.
164	Riparian restoration	WQ, Soils/SEZ, Fish	N	
165	Livestock: <i>Code of Ordinances</i> Chapter 64	WQ, Soils/SEZ, Fish	N	
166	BMP and revegetation practices	WQ, Fish	N	
167	Fish habitat study	Fish	N	No change to fish habitat study.
168	Remedial Action Plans: <i>Code of Ordinances</i> Chapter 5	Fish	N	No impact on remedial action plans.
169	Mitigation Fee Requirements: <i>Code of Ordinances</i> Chapter 84	Fish	N	No change to mitigation fee requirements.
170	Compliance inspection	Fish	N	No change to compliance inspections.
171	Public Education Program	Wildlife, Fish	N	No impact to Public Education Program.

NOISE - IN PLACE

172	Airport noise enforcement program	Wildlife, Fish	N	No change to noise enforcement programs.
-----	-----------------------------------	----------------	---	--

Tracking Number	Compliance Measure Description	Affected Threshold Categories	Affected by Action (Y/N)	Comments
173	Boat noise enforcement program	Wildlife, Fish, Rec	N	
174	Motor vehicle/motorcycle noise enforcement program: <i>Code of Ordinances</i> Chapters 5 and 23	Wildlife, Fish	N	
175	ORV restrictions	AQ, Wildlife, Noise, Rec	N	No change to vehicle restrictions.
176	Snowmobile Restrictions	WQ, Wildlife, Noise, Rec	N	
177	Land use planning and controls	Wildlife, Noise	N	No change to land use planning or controls.
178	Vehicle trip reduction programs	Trans, Noise	N	No change to vehicle trip reduction programs.
179	Transportation corridor design criteria	Trans, Noise	N	No change to transportation corridor design criteria.
180	Airport Master Plan South Lake Tahoe	Trans, Noise	N	No impact on Airport Master plan.
181	Loudspeaker restrictions	Wildlife, Noise	N	No change to loudspeaker restrictions.
182	Project Review	Noise	Y	The proposed amendment changes the permit review process for new single-family mooring buoys from Hearings Officer to staff-
183	Complaint system: <i>Code of Ordinances</i> Chapters 5 and 68	Noise	N	No change to complaint system.
184	Transportation corridor compliance program	Trans, Noise	N	No change to noise limitations or compliance programs.
185	Exemptions to noise limitations	Noise	N	
186	TRPA's Environmental Improvement Program (EIP)	Noise	N	
187	Personal watercraft noise controls	Wildlife, Noise	N	
NOISE - SUPPLEMENTAL				
188	Create an interagency noise enforcement MOU for the Tahoe Region.	Noise	N	No impact to interagency noise enforcement MOU.
RECREATION - IN PLACE				
189	Allocation of Development: <i>Code of Ordinances</i> Chapter 50	Rec	N	No impact to allocation of development.
190	Master Plan Guidelines: <i>Code of Ordinances</i> Chapter 14	Rec, Scenic	N	No change to master plan guidelines.
191	Permissible recreation uses in the shorezone and lake zone: <i>Code of Ordinances</i> Chapter 81	WQ, Noise, Rec	N	No change to permissible recreation uses in shorezone or lakezone.
192	Public Outdoor recreation facilities in sensitive lands	WQ, Rec, Scenic	N	No impact to outdoor recreation facilities on sensitive lands.

Tracking Number	Compliance Measure Description	Affected Threshold Categories	Affected by Action (Y/N)	Comments
193	Hiking and riding facilities	Rec	N	No impact to hiking or riding facilities.
194	Scenic quality of recreation facilities	Rec, Scenic	N	The proposed amendment will authorize existing mooring buoys. The amendment will not alter the existing scenic quality of recreation facilities.
195	Density standards	Rec	N	No change to density standards.
196	Bonus incentive program	Rec	N	No change to bonus incentive program.
197	Required Findings: <i>Code of Ordinances</i> Chapter 4	Rec	N	No change to required findings.
198	Lake Tahoe Recreation Sign Guidelines	Rec, Scenic	N	No change to recreation sign guidelines.
199	Annual user surveys	Rec	N	No impact to annual user surveys.
RECREATION - SUPPLEMENTAL				
200	Regional recreational plan	Rec	N	No impact to regional recreation plan.
201	Establish fair share resource capacity estimates	Rec	N	No change to resource capacity.
202	Reserve additional resource capacity	Rec	N	
203	Economic Modeling	Rec	N	
SCENIC - IN PLACE				
204	Project Review and Exempt Activities: <i>Code of Ordinances</i> Chapter 2	Scenic	Y	The proposed amendment changes the permit review process for new single-family mooring buoys from Hearings Officer to staff-level. It does not change any compliance requirements including
205	Land Coverage Limitations: <i>Code of Ordinances</i> Chapter 30	WQ, Scenic	N	No change to coverage limitations.
206	Height Standards: <i>Code of Ordinances</i> Chapter 37	Scenic	N	No change to height standards.
207	Driveway and Parking Standards: <i>Code of Ordinances</i> Chapter 34	Trans, Scenic	N	No change to driveway parking standards.
208	Signs: <i>Code of Ordinances</i> Chapter 38	Scenic	N	No impact on sign regulations.
209	Historic Resources: <i>Code of Ordinances</i> Chapter 67	Scenic	N	No impact on historic resources.
210	Design Standards: <i>Code of Ordinances</i> Chapter 36	Scenic	N	No change to design standards.

Tracking Number	Compliance Measure Description	Affected Threshold Categories	Affected by Action (Y/N)	Comments
211	Shorezone Tolerance Districts and Development Standards: <i>Code of Ordinances</i> Chapter 83	Scenic	N	No change to development standards.
212	Development Standards Lakeward of Highwater: <i>Code of Ordinances</i> Chapter 84	WQ, Scenic	N	
213	Grading Standards: <i>Code of Ordinances</i> Chapter 33	WQ, Scenic	N	No impact on grading standards or vegetation protection.
214	Vegetation Protection During Construction: <i>Code of Ordinances</i> Chapter 33	AQ, Veg, Scenic	N	
215	Revegetation: <i>Code of Ordinances</i> Chapter 61	Scenic	N	No impact on revegetation.
216	Design Review Guidelines	Scenic	N	The proposed amendment changes the permit review process for new single-family mooring buoys from Hearings Officer to staff-level. The amendment does not impact design review guidelines.
217	Scenic Quality Improvement Program(SQIP)	Scenic	N	The proposed amendment changes the permit review process for new single-family mooring buoys from Hearings Officer to staff-level. It does not alter the project review packet, SQIP, or scenic quality ratings.
218	Project Review Information Packet	Scenic	N	
219	Scenic Quality Ratings, Features Visible from Bike Paths and Outdoor Recreation Areas Open to the General Public	Trans, Scenic	N	
220	Nevada-side Utility Line Undergrounding Program	Scenic	N	No impact to Nevada-side Utility Line Undergrounding Program.
SCENIC - SUPPLEMENTAL				
221	Real Time Monitoring Program	Scenic	N	No change to real time monitoring program.
222	Integrate project identified in SQIP	Scenic	N	No impact to SQIP.